



## Former TGI Friday's

2441 N. Maize Road, #1401 Wichita, Kansas 67205

### Property Highlights

- Free-standing restaurant in NW Wichita's leading lifestyle shopping center, New Market Square (840,000 SF)
- Strong mix of retail, restaurant and service users anchored by Target & Walmart, and junior anchors Marshall's, Michael's, Ross, & Best Buy
- Signalized entrance with signage fronting Maize Rd.
- Built in 2006
- Located at the 1st signalized entrance to New Market Square north of 21st St on Maize
- Join casual dining, limited service and quick serve local & national concepts such as Bella Luna Cafe, Home Grown, Olive Garden, On the Border, Walk-On's Sports Bisteaux, Meddy's Mediterranean, Chipotle, Starbucks and Panera
- Traffic Counts: 45,000 VPD at 21st & Maize
- Lease Rate: \$24.00/SF NNN
- Sale Price: \$1,500,000

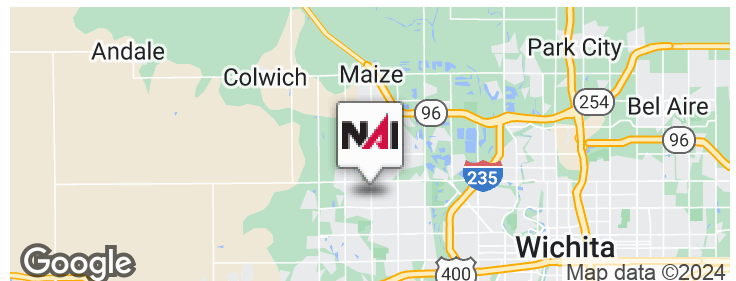

[View Property Video](#)

### For More Information

**Troy Farha**

O: 316 847 4904

tfarha@naimartens.com











### Site Plan

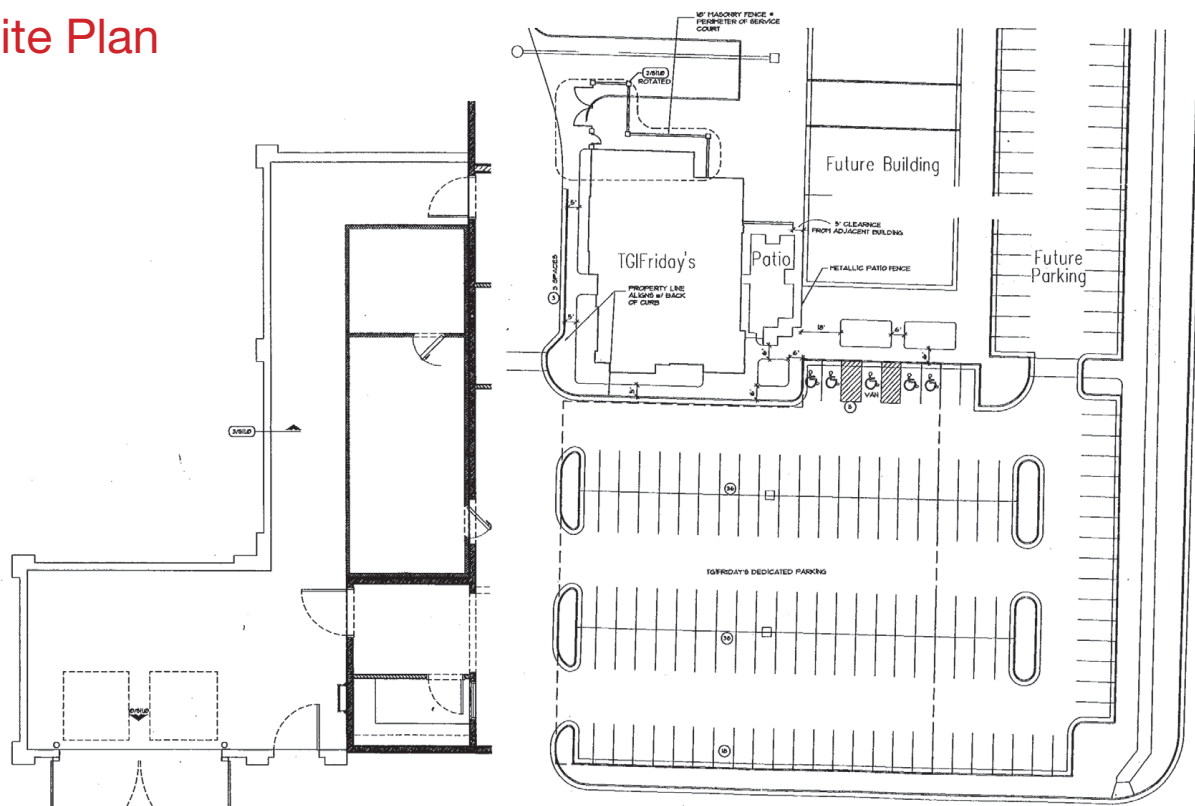

### Floor Plan

