

# FOR SALE

7030 S Broadway Haysville, KS 67060

# Naimartens



## Medical Office Building

- Move-in ready medical clinic located in Haysville, KS
- 8,291 square feet
- Built in 2003
- Lot size: 2.09 acres
- 38 parking stalls
- Sale Price: \$800,000





# Medical Office

Haysville, KS

**Naim**Martens



✉ **Grant Glasgow, SIOR**  
+1 316 847 4908  
gglasgow@naimartens.com

No Warranty Or Representation, Express Or Implied, Is Made As To The Accuracy Of The Information Contained Herein, And The Same Is Submitted Subject To Errors, Omissions, Change Of Price, Rental Or Other Conditions, Prior Sale, Lease Or Financing, Or Withdrawal Without Notice, And Of Any Special Listing Conditions Imposed By Our Principals. No Warranties Or Representations Are Made As To The Condition Of The Property Or Any Hazards Contained Therein Are Any To Be Implied.

**Naim**Martens



# Medical Office

Haysville, KS

**Naimartens**



✉ **Grant Glasgow, SIOR**  
+1 316 847 4908  
gglasgow@naimartens.com

No Warranty Or Representation, Express Or Implied, Is Made As To The Accuracy Of The Information Contained Herein, And The Same Is Submitted Subject To Errors, Omissions, Change Of Price, Rental Or Other Conditions, Prior Sale, Lease Or Financing, Or Withdrawal Without Notice, And Of Any Special Listing Conditions Imposed By Our Principals. No Warranties Or Representations Are Made As To The Condition Of The Property Or Any Hazards Contained Therein Are Any To Be Implied.

**Naimartens**



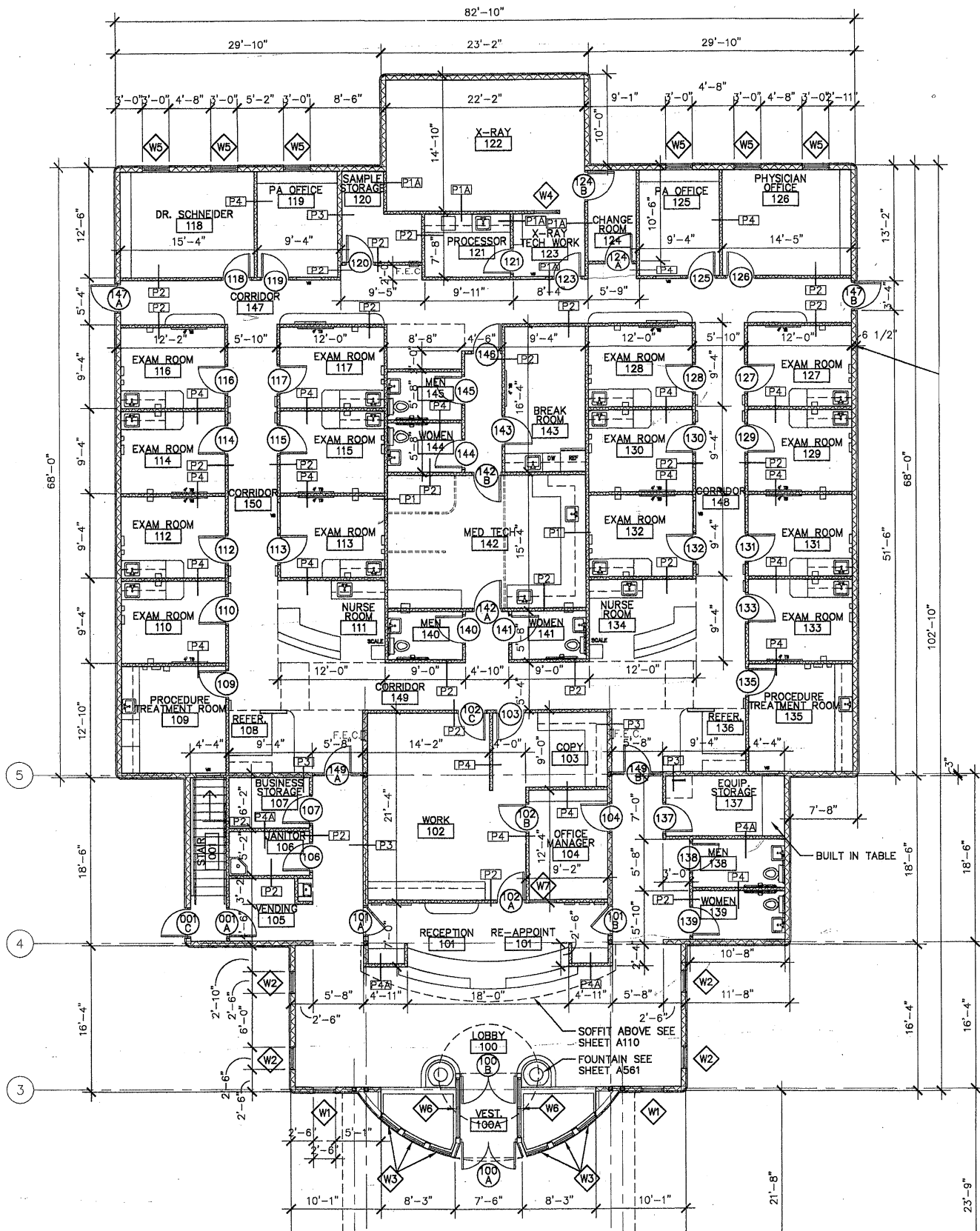



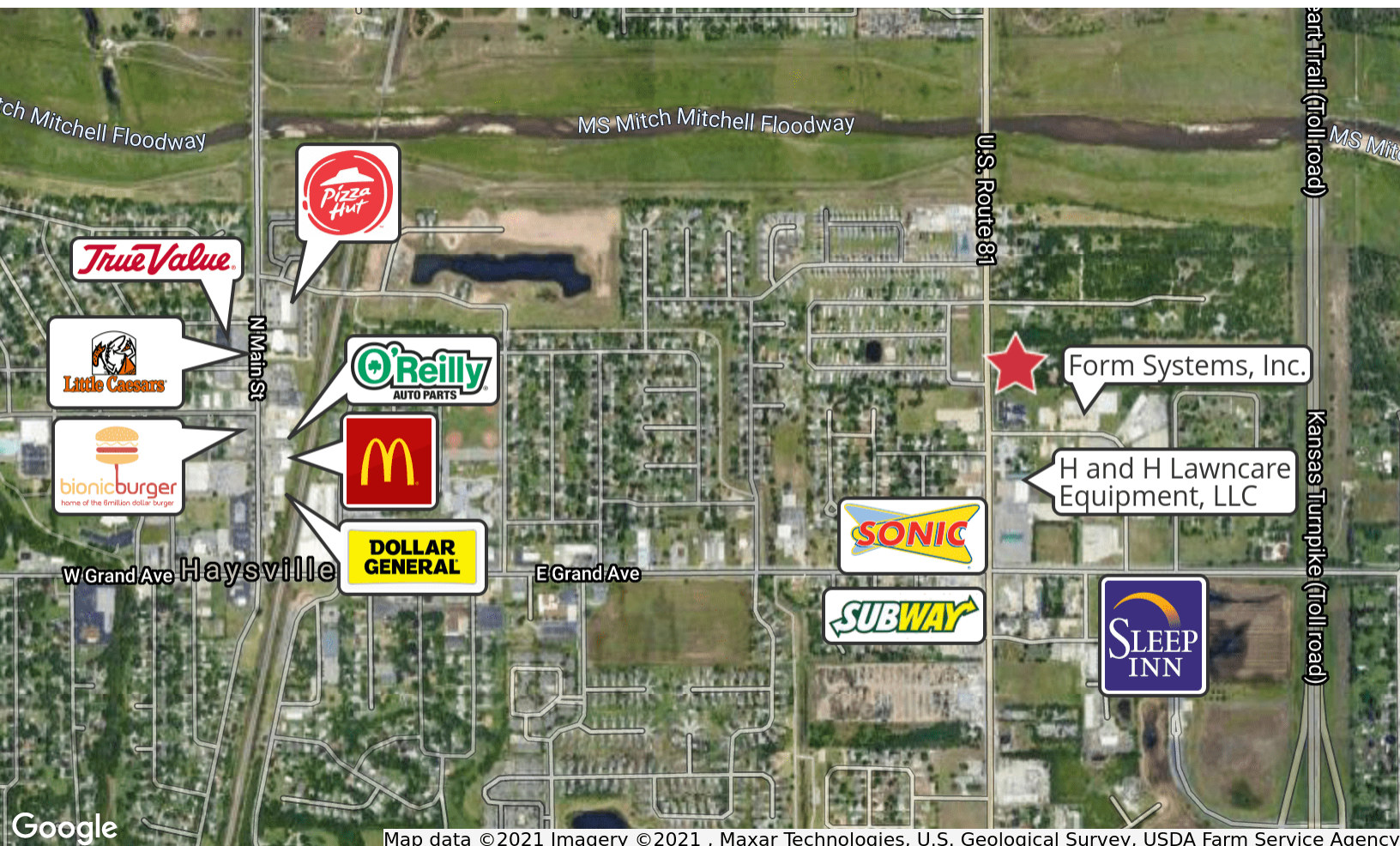
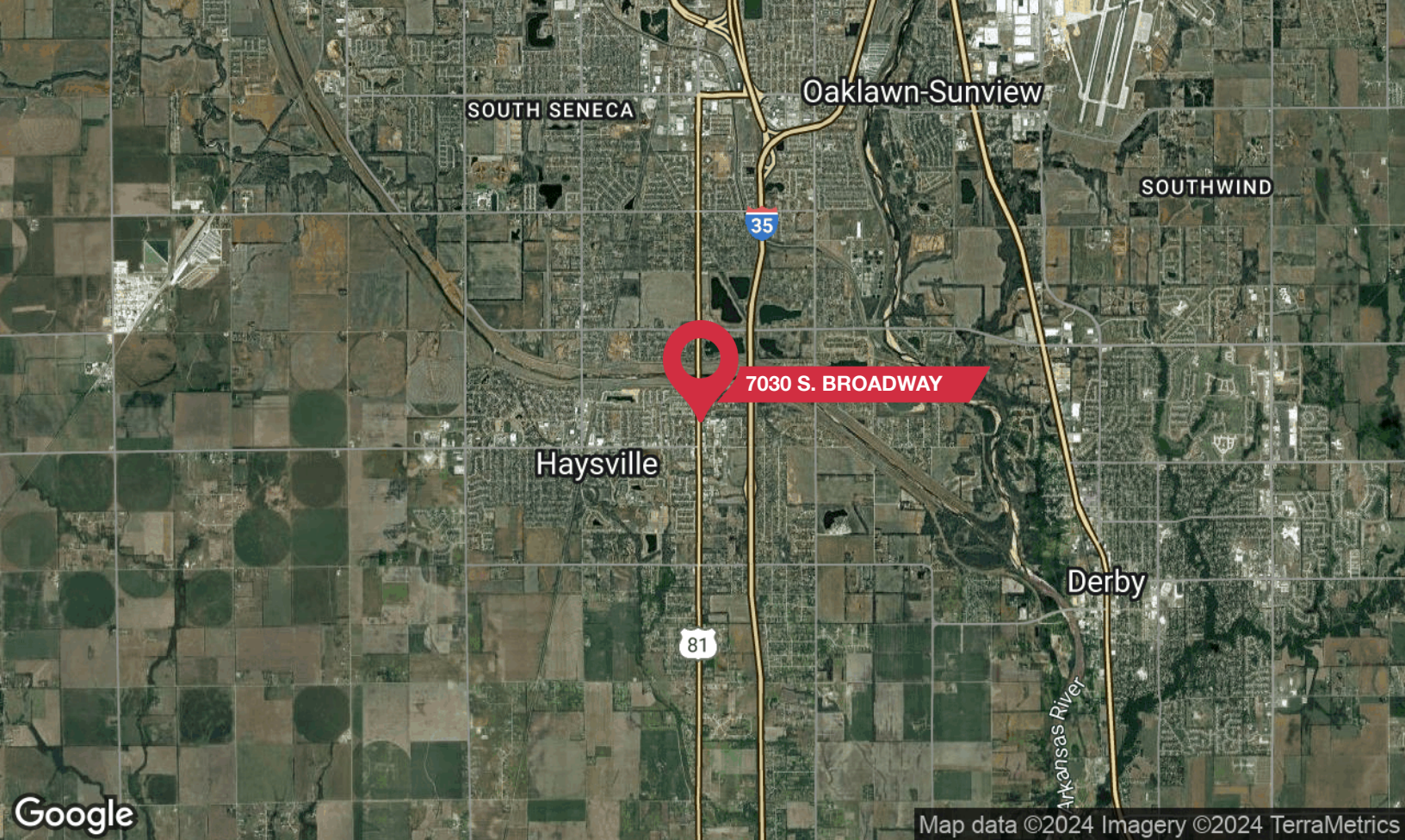

✉ **Grant Glasgow, SIOR**  
+1 316 847 4908  
gglasgow@naimartens.com

No Warranty Or Representation, Express Or Implied, Is Made As To The Accuracy Of The Information Contained Herein, And The Same Is Submitted Subject To Errors, Omissions, Change Of Price, Rental Or Other Conditions, Prior Sale, Lease Or Financing, Or Withdrawal Without Notice, And Of Any Special Listing Conditions Imposed By Our Principals. No Warranties Or Representations Are Made As To The Condition Of The Property Or Any Hazards Contained Therein Are Any To Be Implied.

**Naimartens**