

FOR LEASE

2101 N 14th Avenue Dodge City, KS 67801



NaimMartens Hy-Plains Shopping Center

- Shopping Center in main retail corridor of Dodge City
- Wal-Mart Supercenter Shadow Anchor
- Traffic Count: 15,590 vehicles per day
- Total Center Size: 85,029 SF
 - Suite 100: 53,300 SF available - \$4/SF NNN (space can be divided)
 - Suite 300: 8,000 SF available - \$6/SF NNN
 - Suite 300A: 10,763 SF available - \$6/SF NNN
- NNN Expense: \$2.03/SF



No Warranty Or Representation, Express Or Implied, Is Made As To The Accuracy Of The Information Contained Herein, And The Same Is Submitted Subject To Errors, Omissions, Change Of Price, Rental Or Other Conditions, Prior Sale, Lease Or Financing, Or Withdrawal Without Notice, And Of Any Special Listing Conditions Imposed By Our Principals No Warranties Or Representations Are Made As To The Condition Of The Property Or Any Hazards Contained Therein Are Any To Be Implied.

✉ **Drew Gannon, CCIM**
+1 316 680 1108
dgannon@naimartens.com

NaimMartens

HY-PLAINS SHOPPING CENTER

DODGE CITY, KANSAS



LOCATION MAP

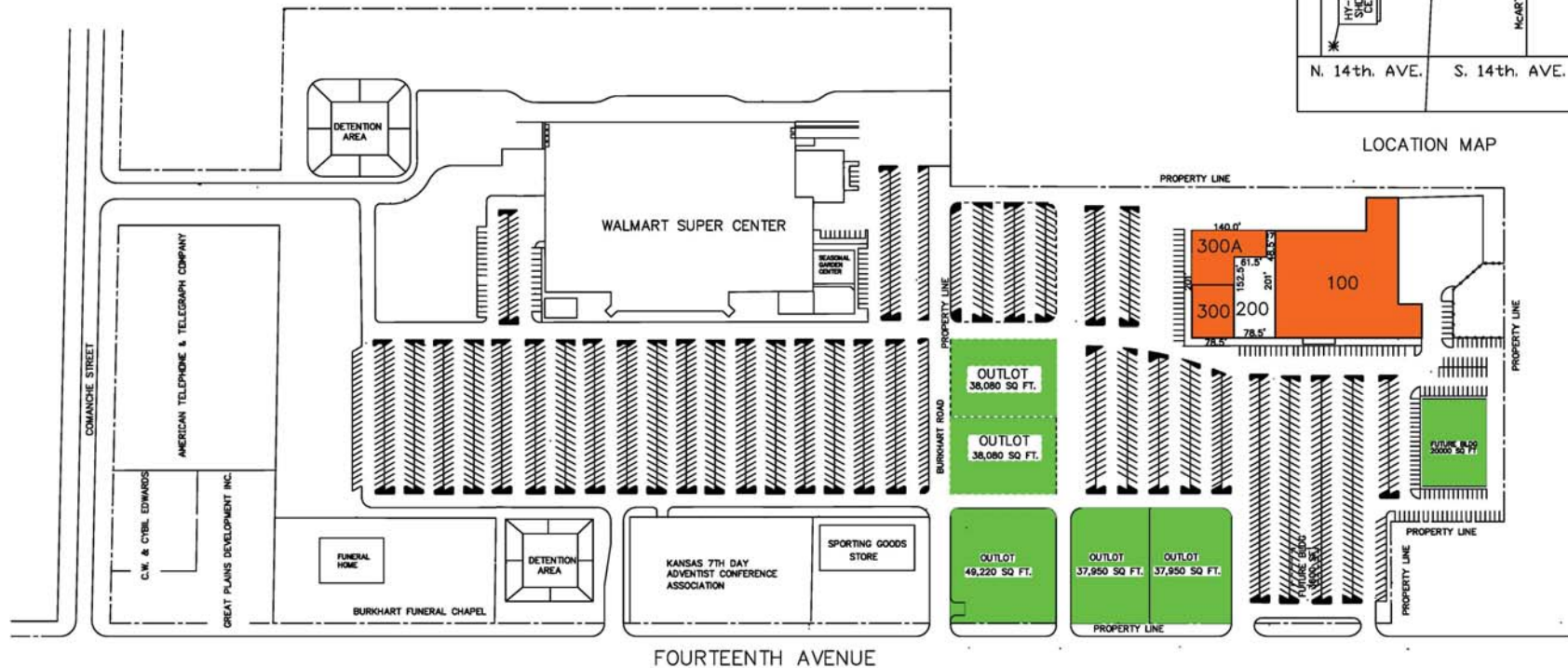

Center # 050	Hy-Plains Center Tenants	
Unit	Sq. Ft.	Tenant Name
100	53,300	AVAILABLE
200	12,966	Dollar Tree
300	8,000	AVAILABLE
300A	10,763	AVAILABLE
	85,029	TOTAL SQUARE FEET



FOR LEASE

2101 N 14th Avenue Dodge City, KS 67801



Google

Map data ©2021 Imagery ©2021 , Maxar Technologies, USDA Farm Service Agency

No Warranty Or Representation, Express Or Implied, Is Made As To The Accuracy Of The Information Contained Herein, And The Same Is Submitted Subject To Errors, Omissions, Change Of Price, Rental Or Other Conditions, Prior Sale, Lease Or Financing, Or Withdrawal Without Notice, And Of Any Special Listing Conditions Imposed By Our Principals No Warranties Or Representations Are Made As To The Condition Of The Property Or Any Hazards Contained Therein Are Any To Be Implied.

✉ **Drew Gannon, CCIM**
+1 316 680 1108
dgannon@naimartens.com

Naimartens

FOR LEASE

2101 N 14th Avenue Dodge City, KS 67801

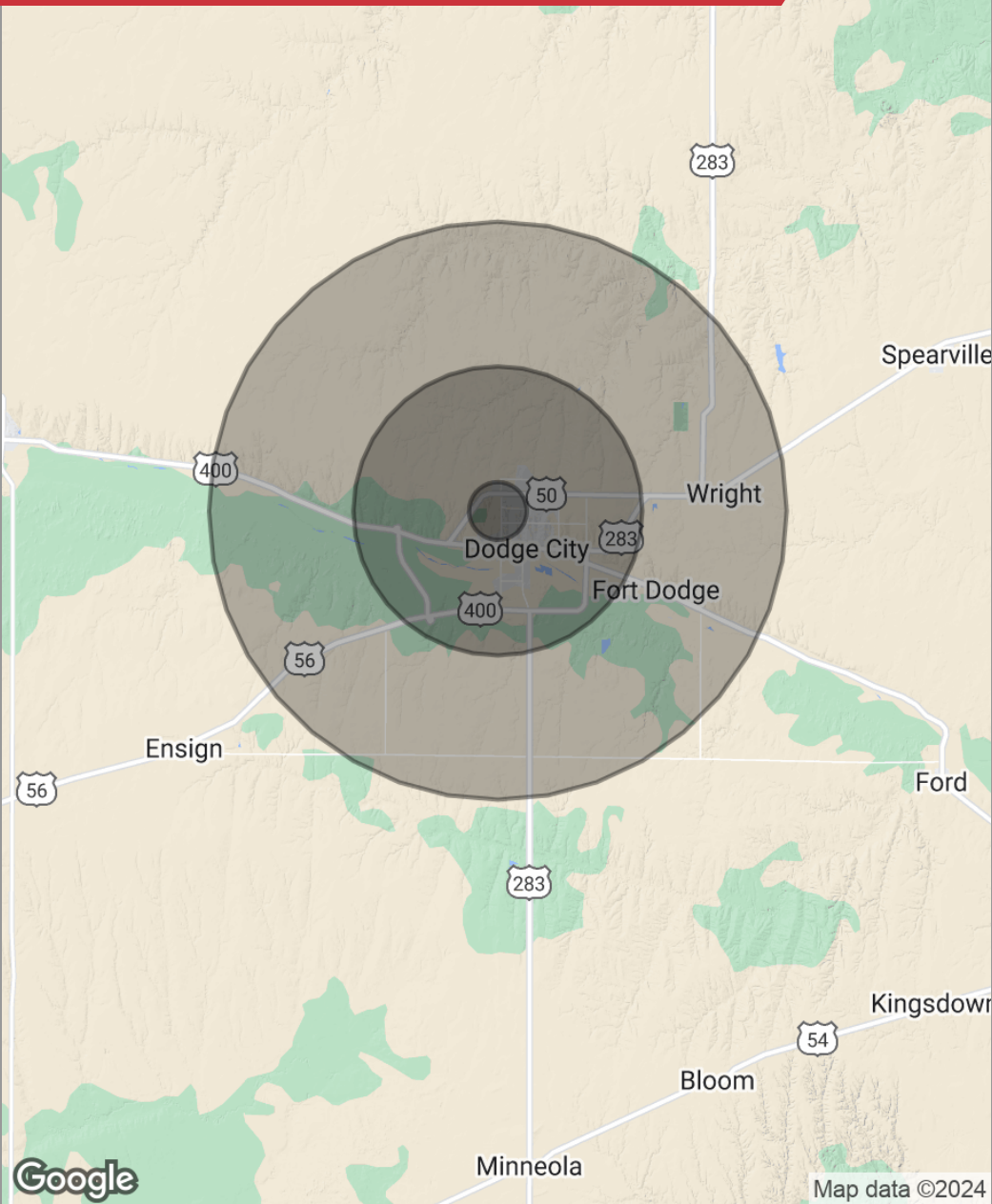

Population	1 Mile	5 Miles	10 Miles
Total population	1,212	23,417	36,941
Median age	32.5	31.5	32.2
Median age (male)	32.1	30.5	30.7
Median age (Female)	32.8	31.6	32.5

Households & Income	1 Mile	5 Miles	10 Miles
Total households	404	7,707	12,333
# of persons per HH	3.0	3.0	3.0
Average HH income	\$60,407	\$54,314	\$53,659
Average house value			

* Demographic data derived from 2020 ACS - US Census

No Warranty Or Representation, Express Or Implied, Is Made As To The Accuracy Of The Information Contained Herein, And The Same Is Submitted Subject To Errors, Omissions, Change Of Price, Rental Or Other Conditions, Prior Sale, Lease Or Financing, Or Withdrawal Without Notice, And Of Any Special Listing Conditions Imposed By Our Principals No Warranties Or Representations Are Made As To The Condition Of The Property Or Any Hazards Contained Therein Are Any To Be Implied.

✉ **Drew Gannon, CCIM**
+1 316 680 1108
dgannon@naimartens.com

