

# FOR LEASE

Big Box Retail & Build-to-Suit Opportunity

**Naim**Martens

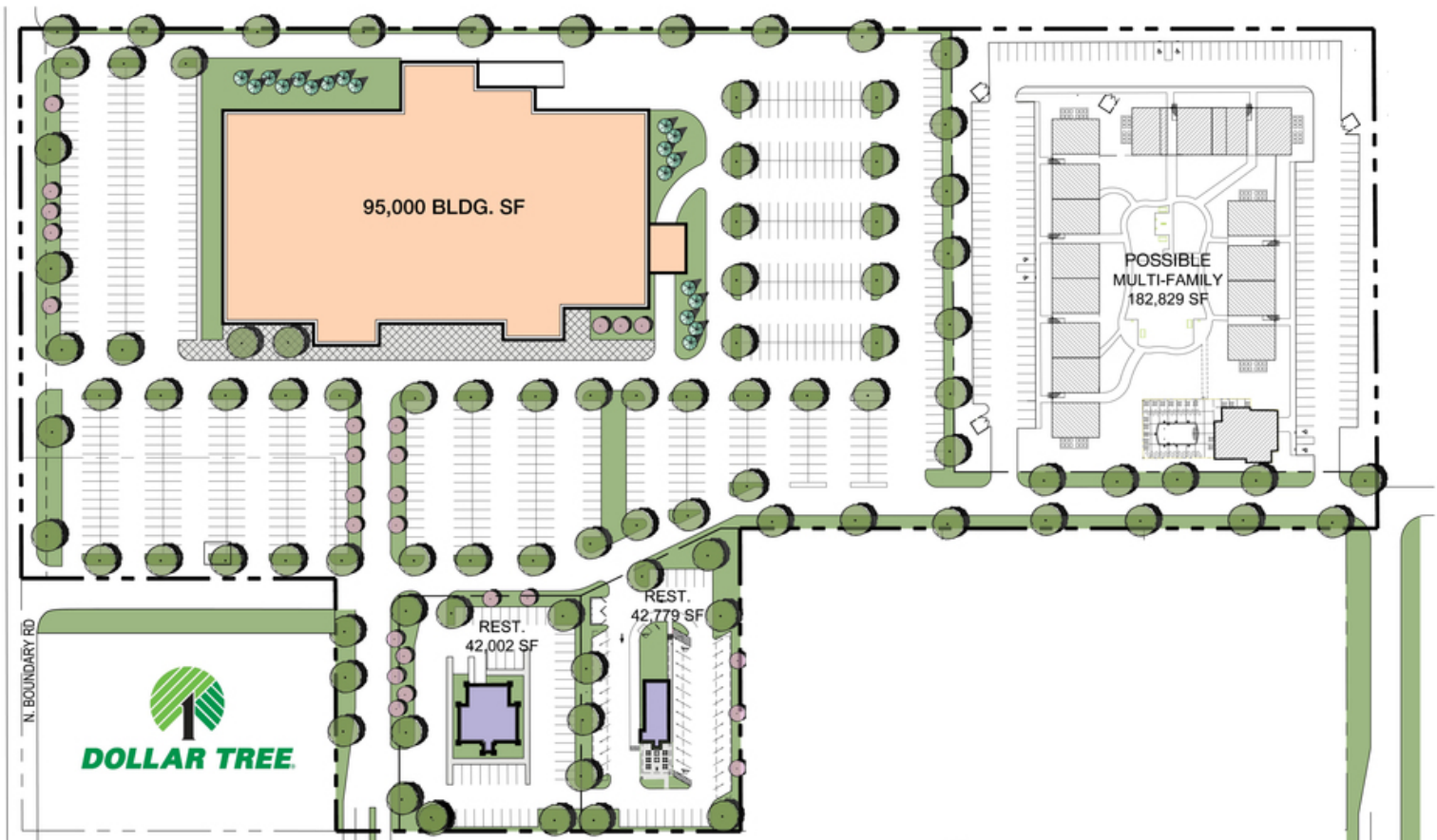

664 E. 10th Ave. | Wellington, KS

- 95,000 SF Retail Space
- 17.8 Acres
- Two Restaurant Pads Available for B-T-S
- Apartment or Senior Living Site
- Located Across the Street from Walmart, Wellington High School, Cowley Community College and McDonald's
- Water, Gas & Electric to Site
- City Sewer on West Side of Property
- Area Users: Taco Bell, KFC, Dollar Tree, Verizon, Dollar General, Sumner Community Hospital, Baymont by Wyndham Hotel
- Lease Price: Negotiable

## DEMOGRAPHICS

STATS	POPULATION	AVG. HH INCOME
1 MILE	596	\$45,302
5 MILES	7,880	\$49,107
10 MILES	13,962	\$54,046

\* Figures shown represent estimates

✉ **Troy Farha**  
+1 316 847 4904  
tfarha@naimartens.com

✉ **Nathan Farha, CCIM**  
+1 316 263 9669  
nfarha@naimartens.com

No Warranty Or Representation, Express Or Implied, Is Made As To The Accuracy Of The Information Contained Herein, And The Same Is Submitted Subject To Errors, Omissions, Change Of Price, Rental Or Other Conditions, Prior Sale, Lease Or Financing, Or Withdrawal Without Notice, And Of Any Special Listing Conditions Imposed By Our Principals. No Warranties Or Representations Are Made As To The Condition Of The Property Or Any Hazards Contained Therein. Any To Be Implied.

**Naim**Martens

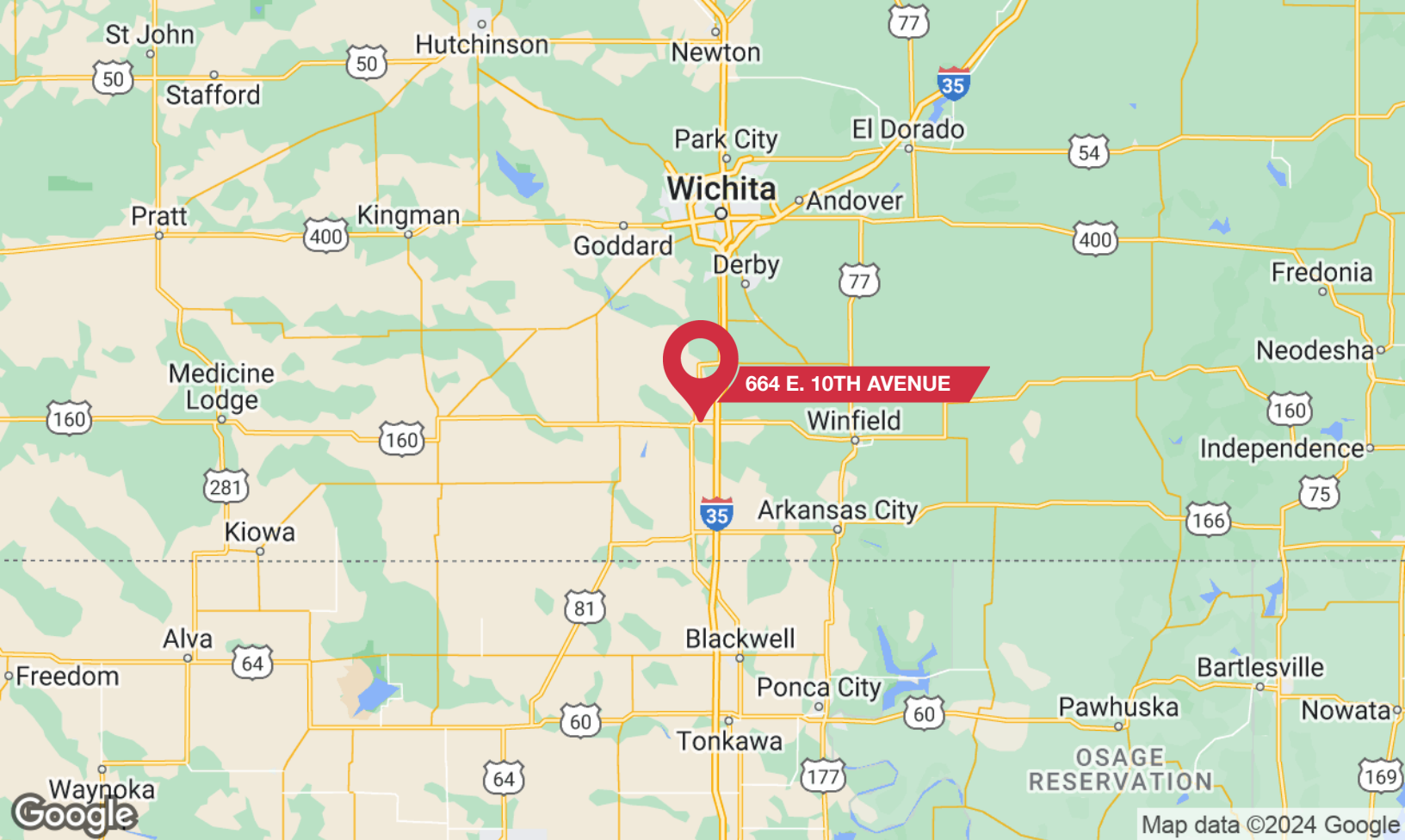

Map data ©2021 Imagery ©2021, Maxar Technologies, USDA Farm Service Agency

No Warranty Or Representation, Express Or Implied, Is Made As To The Accuracy Of The Information Contained Herein, And The Same Is Submitted Subject To Errors, Omissions, Change Of Price, Rental Or Other Conditions, Prior Sale, Lease Or Financing, Or Withdrawal Without Notice, And Of Any Special Listing Conditions Imposed By Our Principals. No Warranties Or Representations Are Made As To The Condition Of The Property Or Any Hazards Contained Therein And Any To Be Implied.

 **Troy Farha**  
+1 316 847 4904  
tfarha@naimartens.com

 **Nathan Farha, CCIM**  
+1 316 263 9669  
nfarha@naimartens.com

