

For Lease

Office Building

16,897 SF | \$5.00 SF/yr



1962 S. Midfield Road

Wichita, Kansas 67209

Property Highlights

- 14 Private Offices
- 7 Training Class Rooms
- 10' Overhead Door with Warehouse Access
- Large Reception Area
- Large Break Room
- New Parking Lot, Sidewalk, Landscape & Irrigation System
- Property Tax Exempt

Property Description

16,897 SF single story free standing office building located on Dwight D. Eisenhower National Airport campus. This office space offers exceptional access to US-400, the main east and west arterial in Wichita. Hotels and business services as well as national restaurants are conveniently located within close proximity. Award winning Eisenhower National Airport serves 7 airlines with 13 non-stop destinations as well as developed a new \$200 Million terminal & 1,600 car parking garage in 2015. Related industry area users include; FedEx, Bombardier Learjet, Textron Aviation, FlightSafety International, Garmin, Honeywell, Pratt & Whitney, and

OFFERING SUMMARY

Available SF	16,897 SF
Lease Rate	\$5.00 SF/yr (NNN)
Monthly Rate	\$7,040.00
Building Size	16,897 SF

For more information

Scott Salome, SIOR

O: 316 847 4903
ssalome@naimartens.com

Patrick Ahern, SIOR, CCIM

O: 316 847 4914
pahern@naimartens.com



1330 E. Douglas Ave.,
Wichita, KS 67214
316 262 0000 tel
naimartens.com



For Lease

Office Building

16,897 SF | \$5.00 SF/yr



Former Aviation Training Room



Conference Space



Warehouse Space

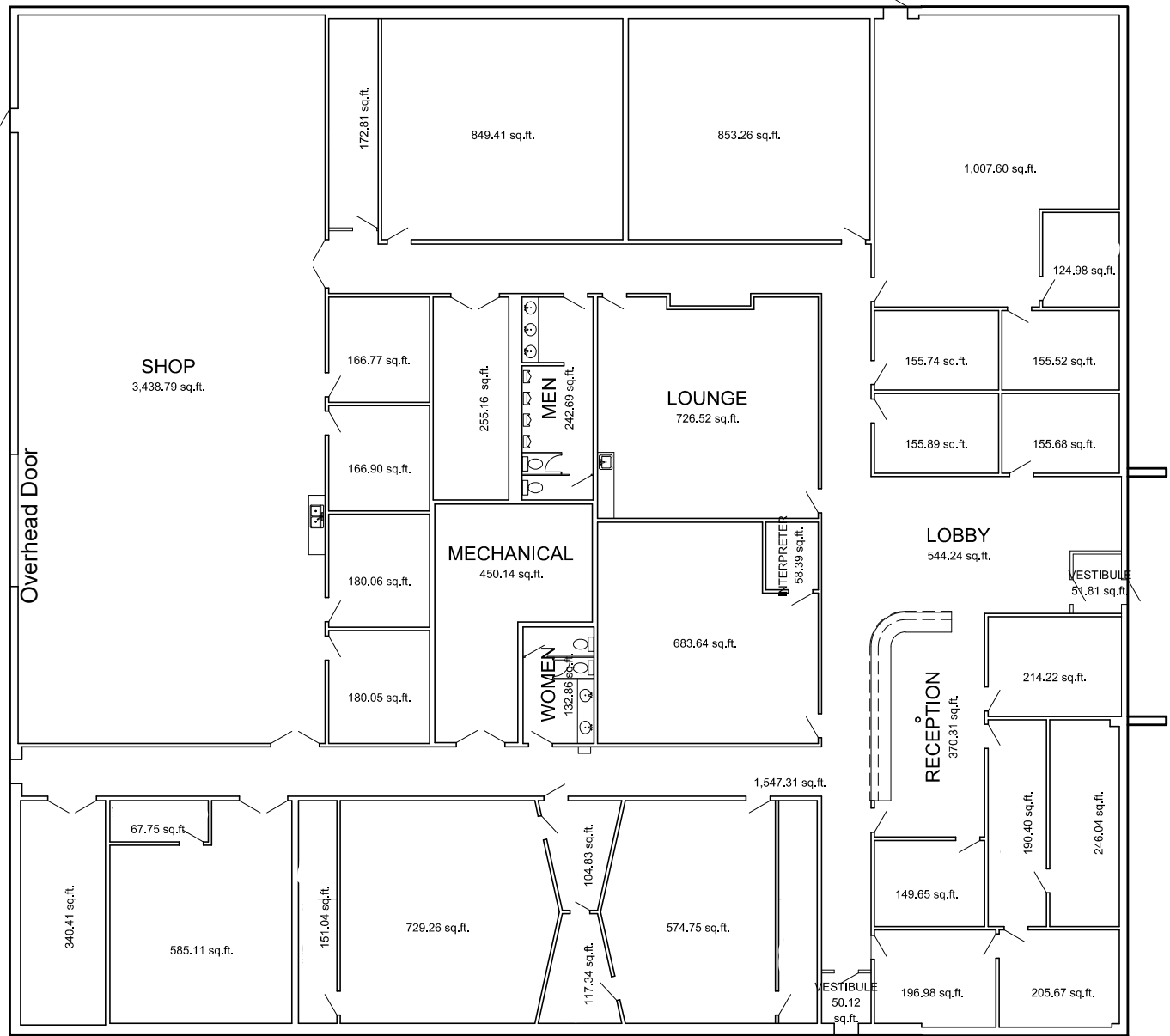

1962 MIDFIELD ROAD

WICHITA DWIGHT D. EISENHOWER
NATIONAL AIRPORT

THE WICHITA AIRPORT AUTHORITY
WICHITA, KANSAS

DATE	DR. BY	SCALE	SHEET
12/20/17	H.G.O.	1" = 20'	1 of 1

For Lease

Office Building

16,897 SF | \$5.00 SF/yr

